

## TEST REPORT

Test Report # 23W-010721 Date of Report Issue: September 7, 2023  
Date of Sample Received: July 26, 2023 Pages: Page 1 of 17

### CLIENT INFORMATION:

Company: Spector & Co.  
Address: testing@spectorandco.com



### SAMPLE INFORMATION:

Description: LUGGAGE TAG  
Assortment: BLK/BLU/GRN/ORG/RED  
PO No.: PO72763  
Item No./Name: G8028  
Item Class: COLORPLAY  
Factory/Supplier: USF019  
Country of Origin: China  
Country of Distribution: Canada, United States  
Testing Period: 07/26/2023-07/31/2023, 09/04/2023-09/07/2023

### OVERALL RESULT:

**🔍 PASS with information**

Please refer to the following pages for test result summary and appropriate notes.

QIMA (HANGZHOU) TESTING CO., LTD.



Jeremy Xu  
Chemical Laboratory Supervisor



Hangzhou QIMA (Hangzhou) Testing Co., Ltd. • Room 401,4-5/F, Building 1, No.1213 Huoju South Road, Puyan Subdistrict, Binjiang District, Hangzhou, China

Email: [Labtesting@qima.com](mailto:Labtesting@qima.com) • Tel: (86) 571 8999 7158.

Test(s) marked with 'ø' was subcontracted to external laboratory.

The test result(s) and conclusion(s) in this report relate only to the sample(s) as received and method /regulation section(s) tested as described herein.

If it is not further specified in the report, the decision rule for stating conformity is based on the QIMA decision rule

<https://www.qima.com/conditions-of-service#decisionRule>.

This test report may not be reproduced in whole or in part, without written approval of QIMA (Hangzhou) Testing Co., Ltd.

**TEST RESULTS SUMMARY:**

At the request of the client, the following tests were conducted:

CONCLUSION	TEST(S) CONDUCTED
PASS	California Proposition 65, Total Lead in Substrate Materials
Not Applicable	Canadian Surface Coating Materials Regulations SOR/2016-193, Total Lead in Stickers, Films and Surface Coating Materials
PASS	Canadian Consumer Products Containing Lead Regulations (SOR/2018-83), Total Lead Content
PASS	California Proposition 65, Total Cadmium in Substrate Materials
Not Applicable	Canadian Surface Coating Materials Regulations SOR/2016-193, Total Mercury in Paints and Surface Coatings
Information only	Client's requirement, Total Nickel content
Information only	Client's Requirement, Total Tungsten content
PASS	CPSC 16 CFR 1307 Prohibition of Children's Toys and Child Care Articles Containing Specified Phthalates (DBP, BBP, DEHP, DINP, DHEXP / DnHP, DCHP, DIBP, DPENP)
PASS	California Proposition 65, Phthalates (DBP, BBP, DEHP, DINP, DIDP, DnHP)
PASS	Canadian Phthalates Regulations SOR/2016-188, Phthalates (DBP, BBP, DEHP, DnOP, DINP, DIDP) in Mouthable Vinyl Materials
PASS	Client's Requirement, Phthalates content



QIMA (Hangzhou) Testing Co., Ltd. ♦ Room 401,4-5/F, Building 1, No.1213 Huoju South Road, Puyan Subdistrict, Binjiang District, Hangzhou, China

Email: [Labtesting@qima.com](mailto:Labtesting@qima.com) ♦ Tel: (86) 571 8999 7158.

*Test(s) marked with 'Ø' was subcontracted to external laboratory.*

*The test result(s) and conclusion(s) in this report relate only to the sample(s) as received and method /regulation section(s) tested as described herein.*

*If it is not further specified in the report, the decision rule for stating conformity is based on the QIMA decision rule*

[\[https://www.qima.com/conditions-of-service#decisionRule\]](https://www.qima.com/conditions-of-service#decisionRule).

*This test report may not be reproduced in whole or in part, without written approval of QIMA (Hangzhou) Testing Co., Ltd.*

**DETAILED RESULTS:**

**California Proposition 65, Total Lead in Substrate Materials**

Test Method: CPSC-CH-E1001-08.3 (Metal), CPSC-CH-E1002-08.3 (Non-Metal)  
 Analytical Method: Inductively Coupled Plasma-Optical Emission Spectrometry

Specimen No.	1+2+3	4+5	6+7+8	9+10	11	Limit (mg/kg)
Test Item	Result (mg/kg)	Result (mg/kg)	Result (mg/kg)	Result (mg/kg)	Result (mg/kg)	
Total Lead (Pb)	ND	ND	ND	ND	ND	<b>100</b>
<b>Conclusion</b>	PASS	PASS	PASS	PASS	PASS	

Specimen No.	13+14+15	16+17	19	20	21	Limit (mg/kg)
Test Item	Result (mg/kg)	Result (mg/kg)	Result (mg/kg)	Result (mg/kg)	Result (mg/kg)	
Total Lead (Pb)	ND	ND	30	ND	ND	<b>100</b>
<b>Conclusion</b>	PASS	PASS	PASS	PASS	PASS	

**Note:**

mg/kg =Milligrams per kilogram

LT = Less than

ND = Not detected (Reporting Limit =15 mg/kg)

Composite results are based on specimen of least mass resulting in highest potential concentration.

**Remark:**

The specification is quoted from client's requirement.



**DETAILED RESULTS:**

**Canadian Consumer Products Containing Lead Regulations (SOR/2018-83), Total Lead Content**

Test Method: ASTM F963-17 Clause 8.3.1  
 Analytical Method: Inductively Coupled Plasma-Optical Emission Spectrometry

Specimen No.	1+2+3	4+5	6+7+8	9+10	11	Limit (mg/kg)
Test Item	Result (mg/kg)	Result (mg/kg)	Result (mg/kg)	Result (mg/kg)	Result (mg/kg)	
Total Lead (Pb)	ND	ND	ND	ND	ND	90
<b>Conclusion</b>	PASS	PASS	PASS	PASS	PASS	

Specimen No.	13+14+15	16+17	18	19	20	Limit (mg/kg)
Test Item	Result (mg/kg)	Result (mg/kg)	Result (mg/kg)	Result (mg/kg)	Result (mg/kg)	
Total Lead (Pb)	ND	ND	ND	30	ND	90
<b>Conclusion</b>	PASS	PASS	PASS	PASS	PASS	

Specimen No.	21	---	---	---	---	Limit (mg/kg)
Test Item	Result (mg/kg)	Result (mg/kg)	Result (mg/kg)	Result (mg/kg)	Result (mg/kg)	
Total Lead (Pb)	ND	---	---	---	---	90
<b>Conclusion</b>	PASS	---	---	---	---	

*Note:*  
 mg/kg=Milligrams per kilogram)  
 LT = Less than  
 ND = Not detected (Reporting Limit = 15 mg/kg)  
 Composite results are based on specimen of least mass resulting in highest potential concentration.



QIMA (Hangzhou) Testing Co., Ltd. • Room 401,4-5/F, Building 1, No.1213 Huoju South Road, Puyan Subdistrict, Binjiang District, Hangzhou, China  
 Email: [Labtesting@qima.com](mailto:Labtesting@qima.com) • Tel: (86) 571 8999 7158.  
 Test(s) marked with 'φ' was subcontracted to external laboratory.  
 The test result(s) and conclusion(s) in this report relate only to the sample(s) as received and method /regulation section(s) tested as described herein.  
 If it is not further specified in the report, the decision rule for stating conformity is based on the QIMA decision rule  
<https://www.qima.com/conditions-of-service#decisionRule>.  
 This test report may not be reproduced in whole or in part, without written approval of QIMA (Hangzhou) Testing Co., Ltd.

**DETAILED RESULTS:**

**California Proposition 65, Total Cadmium in Substrate Materials**

Test Method: ASTM F963-17 Clause 8.3.1  
 Analytical Method: Inductively Coupled Plasma-Optical Emission Spectrometry

Specimen No.	1+2+3	4+5	6+7+8	9+10	11	Limit (mg/kg)
Test Item	Result (mg/kg)	Result (mg/kg)	Result (mg/kg)	Result (mg/kg)	Result (mg/kg)	
Total Cadmium (Cd)	ND	ND	ND	ND	ND	<b>75</b>
<b>Conclusion</b>	PASS	PASS	PASS	PASS	PASS	

Specimen No.	13+14+15	16+17	19	20	21	Limit (mg/kg)
Test Item	Result (mg/kg)	Result (mg/kg)	Result (mg/kg)	Result (mg/kg)	Result (mg/kg)	
Total Cadmium (Cd)	ND	ND	ND	ND	ND	<b>75</b>
<b>Conclusion</b>	PASS	PASS	PASS	PASS	PASS	

*Note:*  
 mg/kg = Milligrams per kilogram  
 LT = Less than  
 ND = Not detected (Reporting Limit = 15 mg/kg)  
 Composite results are based on specimen of least mass resulting in highest potential concentration.

*Remark:*  
 The specification is quoted from client's requirement.



**DETAILED RESULTS:**

**Client's requirement, Total Nickel content**

Test Method: US EPA 3052:1996 & US EPA 6010D:2014  
 Analytical Method: Inductively Coupled Plasma-Optical Emission Spectrometry

Specimen No.	19+20+21	---	---	---	---	Limit (mg/kg)
Test Item	Result (mg/kg)	Result (mg/kg)	Result (mg/kg)	Result (mg/kg)	Result (mg/kg)	
Total Nickel (Ni)	18172	---	---	---	---	
<b>Conclusion</b>	Information only	---	---	---	---	

*Note:*

mg/kg = Milligrams per kilogram

ND = Not detected (report limit = 30 mg/kg)

Composite results are based on specimen of least mass resulting in highest potential concentration.



(Hangzhou) QIMA (Hangzhou) Testing Co., Ltd. ♦ Room 401,4-5/F, Building 1, No.1213 Huoju South Road, Puyan Subdistrict, Binjiang District, Hangzhou, China

Email: [Labtesting@qima.com](mailto:Labtesting@qima.com) ♦ Tel: (86) 571 8999 7158.

*Test(s) marked with 'φ' was subcontracted to external laboratory.*

*The test result(s) and conclusion(s) in this report relate only to the sample(s) as received and method /regulation section(s) tested as described herein.*

*If it is not further specified in the report, the decision rule for stating conformity is based on the QIMA decision rule*

<https://www.qima.com/conditions-of-service#decisionRule>.

*This test report may not be reproduced in whole or in part, without written approval of QIMA (Hangzhou) Testing Co., Ltd.*

**DETAILED RESULTS:**

**Client's Requirement, Total Tungsten content**

Test Method: US EPA 3052:1996 & US EPA 6010D:2014  
 Analytical Method: Inductively Coupled Plasma-Optical Emission Spectrometry

Specimen No.	19+20+21	---	---	---	---	Limit (mg/kg)
Test Item	Result (mg/kg)	Result (mg/kg)	Result (mg/kg)	Result (mg/kg)	Result (mg/kg)	
Total Tungsten (W)	ND	---	---	---	---	
<b>Conclusion</b>	Information only	---	---	---	---	

*Note:*

mg/kg = Milligrams per kilogram

LT = Less than

ND = Not detected (Reporting Limit = 15 mg/kg)

Composite results are based on specimen of least mass resulting in highest potential concentration.



**DETAILED RESULTS:**

**CPSC 16 CFR 1307 Prohibition of Children’s Toys and Child Care Articles Containing Specified Phthalates (DBP, BBP, DEHP, DINP, DHEXP / DnHP, DCHP, DIBP, DPENP)**

Test Method: CPSC-CH-C1001-09.4  
 Analytical Method: Gas Chromatography with Mass Spectrometry

Specimen No.		1+2+3	4+5	6+7+8	9+10	Limit (mg/kg)
Test Item	CAS No.	Result (mg/kg)	Result (mg/kg)	Result (mg/kg)	Result (mg/kg)	
Dibutyl phthalate (DBP)	84-74-2	ND	ND	ND	ND	1000
Benzyl butyl phthalate (BBP)	85-68-7	ND	ND	ND	ND	1000
Di-(2-ethylhexyl) phthalate (DEHP)	117-81-7	ND	176	ND	ND	1000
Diisononyl phthalate (DINP)	28553-12-0 68515-48-0	ND	ND	ND	ND	1000
Di-n-hexyl phthalate (DHEXP / DnHP)	84-75-3	ND	ND	ND	ND	1000
Dicyclohexyl phthalate (DCHP)	84-61-7	ND	ND	ND	ND	1000
Diisobutyl phthalate (DIBP)	84-69-5	ND	ND	ND	ND	1000
Di-n-pentyl phthalate (DPENP)	131-18-0	ND	ND	ND	ND	1000
<b>Conclusion</b>		PASS	PASS	PASS	PASS	

*Note:*  
 mg/kg = Milligrams per kilogram  
 LT = Less than  
 ND = Not detected (Reporting Limit = 150 mg/kg)  
 Composite results are based on specimen of least mass resulting in highest potential concentration.





**DETAILED RESULTS:**

**CPSC 16 CFR 1307 Prohibition of Children’s Toys and Child Care Articles Containing Specified Phthalates (DBP, BBP, DEHP, DINP, DHEXP / DnHP, DCHP, DIBP, DPENP)**

Test Method: CPSC-CH-C1001-09.4  
 Analytical Method: Gas Chromatography with Mass Spectrometry

Specimen No.	11	---	---	---	Limit (mg/kg)
Test Item CAS No.	Result (mg/kg)	Result (mg/kg)	Result (mg/kg)	Result (mg/kg)	
Dibutyl phthalate (DBP) 84-74-2	ND	---	---	---	1000
Benzyl butyl phthalate (BBP) 85-68-7	ND	---	---	---	1000
Di-(2-ethylhexyl) phthalate (DEHP) 117-81-7	ND	---	---	---	1000
Diisononyl phthalate (DINP) 28553-12-0 68515-48-0	ND	---	---	---	1000
Di-n-hexyl phthalate (DHEXP / DnHP) 84-75-3	ND	---	---	---	1000
Dicyclohexyl phthalate (DCHP) 84-61-7	ND	---	---	---	1000
Diisobutyl phthalate (DIBP) 84-69-5	ND	---	---	---	1000
Di-n-pentyl phthalate (DPENP) 131-18-0	ND	---	---	---	1000
<b>Conclusion</b>	PASS	---	---	---	

*Note:*  
 mg/kg = Milligrams per kilogram  
 LT = Less than  
 ND = Not detected (Reporting Limit = 150 mg/kg)



**DETAILED RESULTS:**

**California Proposition 65, Phthalates (DBP, BBP, DEHP, DINP, DIDP, DnHP)**

Test Method: CPSC-CH-C1001-09.4  
 Analytical Method: Gas Chromatography with Mass Spectrometry

Specimen No.		1+2+3	4+5	6+7+8	9+10	Limit (mg/kg)
Test Item	CAS No.	Result (mg/kg)	Result (mg/kg)	Result (mg/kg)	Result (mg/kg)	
Dibutyl phthalate (DBP)	84-74-2	ND	ND	ND	ND	1000
Benzyl butyl phthalate (BBP)	85-68-7	ND	ND	ND	ND	1000
Di-(2-ethylhexyl) phthalate (DEHP)	117-81-7	ND	176	ND	ND	1000
Diisononyl phthalate (DINP)	28553-12-0 68515-48-0	ND	ND	ND	ND	1000
Diisodecyl phthalate (DIDP)	26761-40-0 68515-49-1	ND	ND	ND	ND	1000
Di-n-hexyl phthalate (DnHP)	84-75-3	ND	ND	ND	ND	1000
<b>Conclusion</b>		PASS	PASS	PASS	PASS	

**Note:**  
 mg/kg (Milligrams per kilogram) = 0.0001 % w/w (Percent by weight)  
 LT = Less than  
 ND = Not detected (Reporting Limit = 150 mg/kg)  
 Composite results are based on specimen of least mass resulting in highest potential concentration.

**Remark:**  
 The specification is quoted from client's requirement.



**DETAILED RESULTS:**

**California Proposition 65, Phthalates (DBP, BBP, DEHP, DINP, DIDP, DnHP)**

Test Method: CPSC-CH-C1001-09.4  
 Analytical Method: Gas Chromatography with Mass Spectrometry

Specimen No.	11	---	---	---	Limit (mg/kg)
Test Item CAS No.	Result (mg/kg)	Result (mg/kg)	Result (mg/kg)	Result (mg/kg)	
Dibutyl phthalate (DBP) 84-74-2	ND	---	---	---	1000
Benzyl butyl phthalate (BBP) 85-68-7	ND	---	---	---	1000
Di-(2-ethylhexyl) phthalate (DEHP) 117-81-7	ND	---	---	---	1000
Diisononyl phthalate (DINP) 28553-12-0 68515-48-0	ND	---	---	---	1000
Diisodecyl phthalate (DIDP) 26761-40-0 68515-49-1	ND	---	---	---	1000
Di-n-hexyl phthalate (DnHP) 84-75-3	ND	---	---	---	1000
<b>Conclusion</b>	PASS	---	---	---	

**Note:**  
 mg/kg (Milligrams per kilogram) = 0.0001 % w/w (Percent by weight)  
 LT = Less than  
 ND = Not detected (Reporting Limit = 150 mg/kg)

**Remark:**  
 The specification is quoted from client's requirement.



**DETAILED RESULTS:**

**Canadian Phthalates Regulations SOR/2016-188, Phthalates (DBP, BBP, DEHP, DnOP, DINP, DIDP) in Mouthable Vinyl Materials**

Test Method: CPSC-CH-C1001-09.4  
 Analytical Method: Gas Chromatography with Mass Spectrometry

**Vinyl material foreseeable be placed in the mouth**

Specimen No.		6+7+8	9+10	11	---	Limit (mg/kg)
Test Item	CAS No.	Result (mg/kg)	Result (mg/kg)	Result (mg/kg)	Result (mg/kg)	
Dibutyl phthalate (DBP)	84-74-2	ND	ND	ND	---	1000
Benzyl butyl phthalate (BBP)	85-68-7	ND	ND	ND	---	1000
Di-(2-ethylhexyl) phthalate (DEHP)	117-81-7	ND	ND	ND	---	1000
Di-n-octyl phthalate (DnOP)	117-84-0	ND	ND	ND	---	1000
Diisononyl phthalate (DINP)	28553-12-0 68515-48-0	ND	ND	ND	---	1000
Diisodecyl phthalate (DIDP)	26761-40-0 68515-49-1	ND	ND	ND	---	1000
<b>Conclusion</b>		PASS	PASS	PASS	---	

*Note:*  
 mg/kg = Milligrams per kilogram  
 LT = Less than  
 ND = Not detected (Reporting Limit = 150 mg/kg)  
 Composite results are based on specimen of least mass resulting in highest potential concentration.



## DETAILED RESULTS:

### Client's Requirement, Phthalates content

Test Method: CPSC-CH-C1001-09.4  
 Analytical Method: Gas Chromatography with Mass Spectrometry

Specimen No.		1+2+3	4+5	6+7+8	9+10	Limit (mg/kg)
Test Item	CAS No.	Result (mg/kg)	Result (mg/kg)	Result (mg/kg)	Result (mg/kg)	
Dibutyl phthalate (DBP)	84-74-2	ND	ND	ND	ND	1000
Benzyl butyl phthalate (BBP)	85-68-7	ND	ND	ND	ND	1000
Di-(2-ethylhexyl) phthalate (DEHP)	117-81-7	ND	176	ND	ND	1000
Diisononyl phthalate (DINP)	28553-12-0 68515-48-0	ND	ND	ND	ND	1000
Diisodecyl phthalate (DIDP)	26761-40-0 68515-49-1	ND	ND	ND	ND	1000
Di-n-hexyl phthalate (DHEXP / DnHP)	84-75-3	ND	ND	ND	ND	1000
Di-n-octyl phthalate (DNOP)	117-84-0	ND	ND	ND	ND	1000
Diethyl phthalate (DEP)	84-66-2	ND	ND	ND	ND	1000
Diisobutyl phthalate (DIBP)	84-69-5	ND	ND	ND	ND	1000
Dicyclohexyl phthalate (DCHP)	84-61-7	ND	ND	ND	ND	1000
Di-n-pentyl phthalate (DPENP/DnPP)	131-18-0	ND	ND	ND	ND	1000
<b>Conclusion</b>		PASS	PASS	PASS	PASS	

**Note:**

mg/kg (Milligrams per kilogram) = 0.0001 % w/w (Percent by weight)

LT = Less than

ND = Not detected (Reporting Limit = 150 mg/kg)

Composite results are based on specimen of least mass resulting in highest potential concentration.



(Hangzhou) QIMA (Hangzhou) Testing Co., Ltd. • Room 401,4-5/F, Building 1, No.1213 Huoju South Road, Puyan Subdistrict, Binjiang District, Hangzhou, China

Email: [Labtesting@qima.com](mailto:Labtesting@qima.com) • Tel: (86) 571 8999 7158.

Test(s) marked with 'φ' was subcontracted to external laboratory.

The test result(s) and conclusion(s) in this report relate only to the sample(s) as received and method /regulation section(s) tested as described herein.

If it is not further specified in the report, the decision rule for stating conformity is based on the QIMA decision rule

<https://www.qima.com/conditions-of-service#decisionRule>.

This test report may not be reproduced in whole or in part, without written approval of QIMA (Hangzhou) Testing Co., Ltd.

**DETAILED RESULTS:**

**Client's Requirement, Phthalates content**

Test Method: CPSC-CH-C1001-09.4  
 Analytical Method: Gas Chromatography with Mass Spectrometry

Specimen No.		11	---	---	---	Limit (mg/kg)
Test Item	CAS No.	Result (mg/kg)	Result (mg/kg)	Result (mg/kg)	Result (mg/kg)	
Dibutyl phthalate (DBP)	84-74-2	ND	---	---	---	1000
Benzyl butyl phthalate (BBP)	85-68-7	ND	---	---	---	1000
Di-(2-ethylhexyl) phthalate (DEHP)	117-81-7	ND	---	---	---	1000
Diisononyl phthalate (DINP)	28553-12-0 68515-48-0	ND	---	---	---	1000
Diisodecyl phthalate (DIDP)	26761-40-0 68515-49-1	ND	---	---	---	1000
Di-n-hexyl phthalate (DHEXP / DnHP)	84-75-3	ND	---	---	---	1000
Di-n-octyl phthalate (DNOP)	117-84-0	ND	---	---	---	1000
Diethyl phthalate (DEP)	84-66-2	ND	---	---	---	1000
Diisobutyl phthalate (DIBP)	84-69-5	ND	---	---	---	1000
Dicyclohexyl phthalate (DCHP)	84-61-7	ND	---	---	---	1000
Di-n-pentyl phthalate (DPENP/DnPP)	131-18-0	ND	---	---	---	1000
<b>Conclusion</b>		PASS	---	---	---	

**Note:**

mg/kg (Milligrams per kilogram) = 0.0001 % w/w (Percent by weight)

LT = Less than

ND = Not detected (Reporting Limit = 150 mg/kg)

Composite results are based on specimen of least mass resulting in highest potential concentration.



Hangzhou QIMA (Hangzhou) Testing Co., Ltd. • Room 401,4-5/F, Building 1, No.1213 Huoju South Road, Puyan Subdistrict, Binjiang District, Hangzhou, China

Email: [Labtesting@qima.com](mailto:Labtesting@qima.com) • Tel: (86) 571 8999 7158.

Test(s) marked with 'φ' was subcontracted to external laboratory.

The test result(s) and conclusion(s) in this report relate only to the sample(s) as received and method /regulation section(s) tested as described herein.

If it is not further specified in the report, the decision rule for stating conformity is based on the QIMA decision rule

<https://www.qima.com/conditions-of-service#decisionRule>.

This test report may not be reproduced in whole or in part, without written approval of QIMA (Hangzhou) Testing Co., Ltd.

**SPECIMEN DESCRIPTION:**

Specimen No.	Specimen Description	Location
1	Orange synthetic leather	Cover (orange style)
2	Green synthetic leather	Cover (green style)
3	Red synthetic leather	Cover (red style)
4	Black synthetic leather	Cover (black style)
5	Blue synthetic leather	Cover (blue style)
6	Orange synthetic leather	Window frame (orange style)
7	Green synthetic leather	Window frame (green style)
8	Red synthetic leather	Window frame (red style)
9	Black synthetic leather	Window frame (black style)
10	Blue synthetic leather	Window frame (blue style)
11	Transparent soft plastic	Window (blue style)
13	Orange edge oil	Edge oil (orange style)
14	Green edge oil	Edge oil (green style)
15	Red edge oil	Edge oil (red style)
16	Black edge oil	Edge oil (black style)
17	Blue edge oil	Edge oil (blue style)
18	White non-woven textile	Filler (blue style)
19	Silvery metal	Buckle frame (blue style)
20	Silvery metal	Buckle pin (blue style)
21	Silvery metal	Rivet (blue style)



(Hangzhou) QIMA (Hangzhou) Testing Co., Ltd. • Room 401,4-5/F, Building 1, No.1213 Huoju South Road, Puyan Subdistrict, Binjiang District, Hangzhou, China

Email: [Labtesting@qima.com](mailto:Labtesting@qima.com) • Tel: (86) 571 8999 7158.

Test(s) marked with 'ϕ' was subcontracted to external laboratory.

The test result(s) and conclusion(s) in this report relate only to the sample(s) as received and method /regulation section(s) tested as described herein.

If it is not further specified in the report, the decision rule for stating conformity is based on the QIMA decision rule

<https://www.qima.com/conditions-of-service#decisionRule>.

This test report may not be reproduced in whole or in part, without written approval of QIMA (Hangzhou) Testing Co., Ltd.

**SAMPLE PHOTO:**





**SAMPLE PHOTO:**

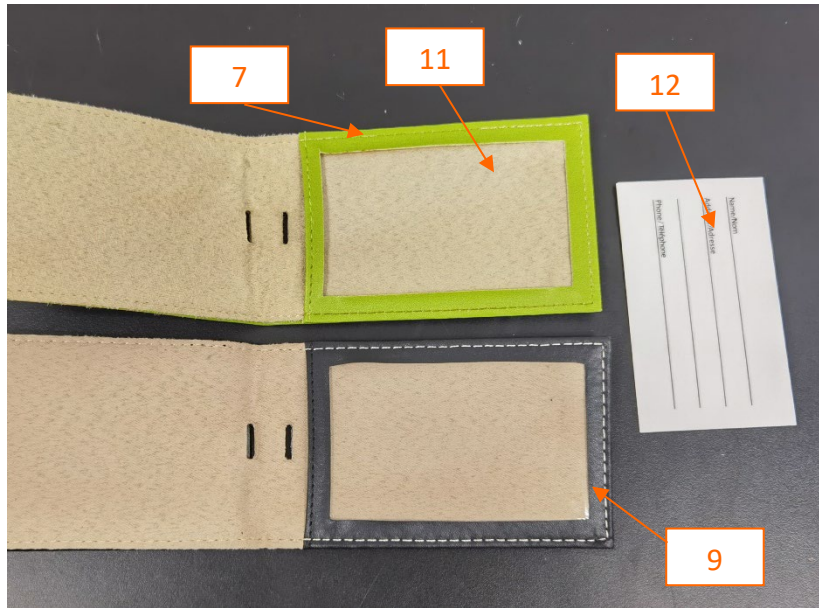

-End Report-

